

HL-93 LOADING CONFIGURATIONS

HL-93 TRUCK

GVW = 72.0 Kips

Lane Load = 0.64 Klf

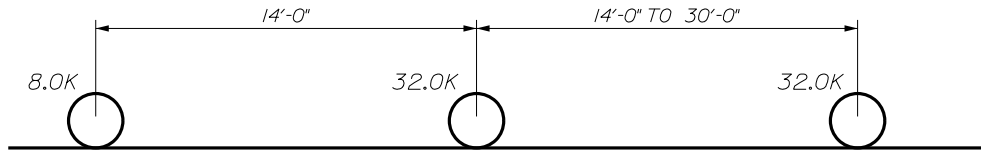

HL-93 TANDEM

GVW = 50.0 Kips

Lane Load = 0.64 Klf

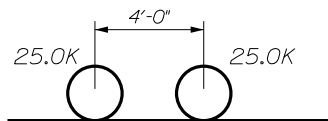

FAST ACT LEGAL LOAD CONFIGURATIONS

FAST ACT EV2

GVW = 57.5 Kips

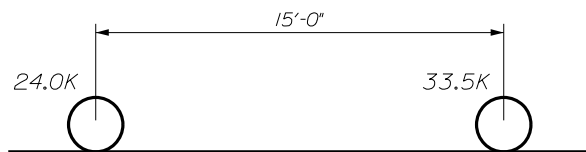

FAST ACT EV3

GVW = 86.0 Kips

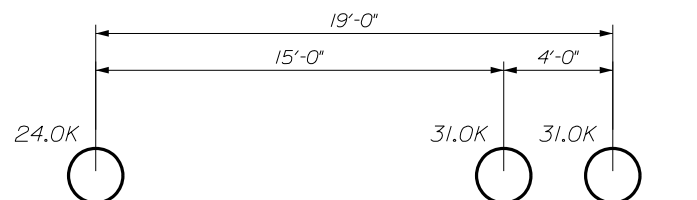

STATE OF MAINE
DEPARTMENT OF TRANSPORTATION

LOADING CONFIGURATIONS
USED FOR BRIDGE RATING

SHEET NUMBER

1

Version 1.3 (3/10/2026)

HL-93, EV2, and EV3

OF 6

MAINEDOT LEGAL LOADS

CONFIGURATION 1:

Six Axle 3 Axle Tractor Triaxle Semi-Trailer = 100 Kips

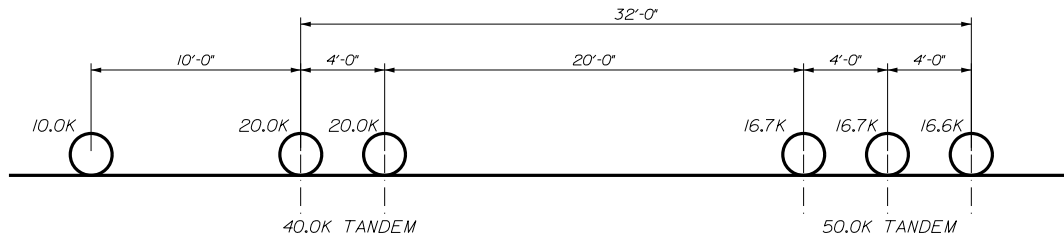

CONFIGURATION 2:

Six Axle Triaxle Truck 2 Axle Trailer = 94 Kips

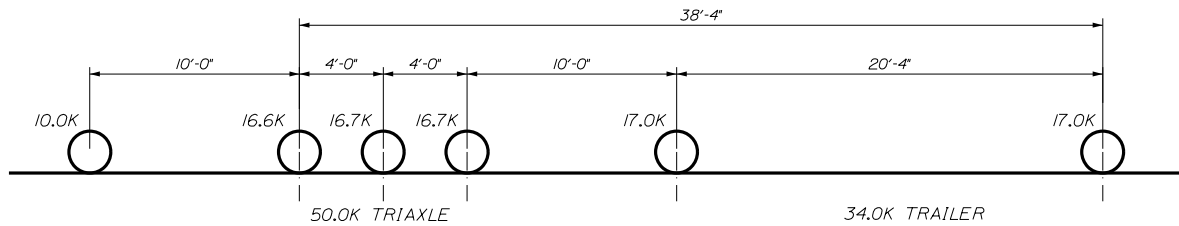

CONFIGURATION 3:

Six Axle Triaxle Truck/Tractor Tandem Semi-Trailer = 88 Kips

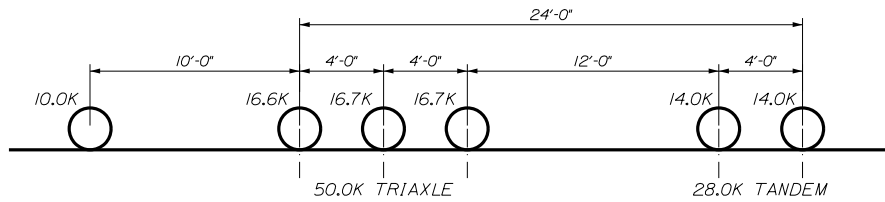

CONFIGURATION 4:

Five Axle Two Axle Truck/Tractor Three Axle Trailer = 88 Kips

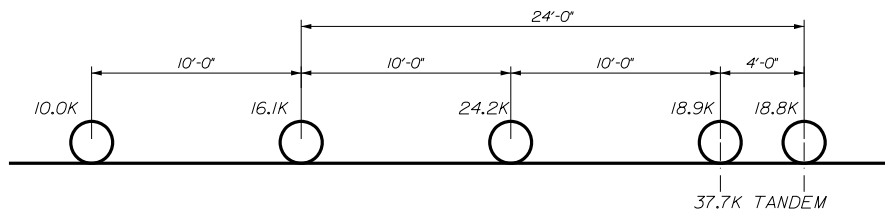

STATE OF MAINE
DEPARTMENT OF TRANSPORTATION

LOADING CONFIGURATIONS
USED FOR BRIDGE RATING

SHEET NUMBER

2

Version 1.3 (3/10/2026)

CONFIGURATIONS 1-4

OF 6

MAINEDOT LEGAL LOADS

CONFIGURATION 5:

FIVE AXLE TANDEM AXLE TRUCK OR TRACTOR SEMI-TRAILER = 88 Kips

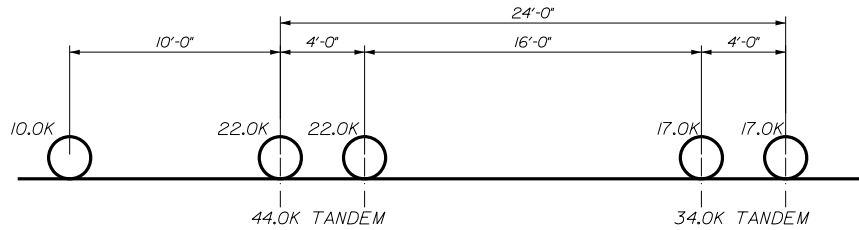

CONFIGURATION 6:

FOUR AXLE TRUCK = 75.9 Kips

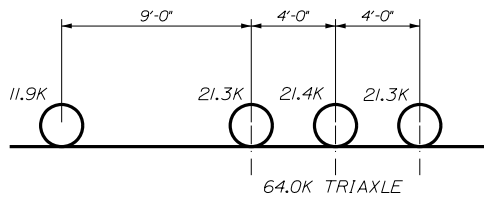

CONFIGURATION 7:

THREE AXLE TRUCK = 59.0 Kips

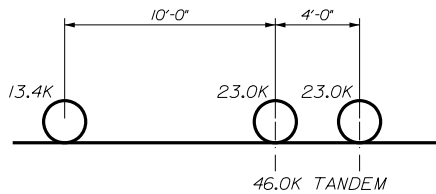

CONFIGURATION 8:

TWO AXLE TRUCK = 37.4 Kips

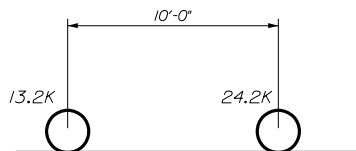

AASHTO SHV CONFIGURATIONS:

SU4 TRUCK

GVW = 54 Kips

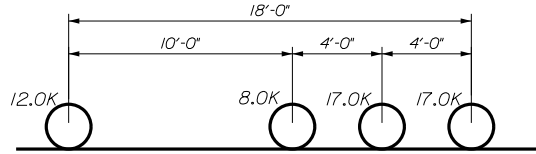

SU5 TRUCK

GVW = 62 Kips

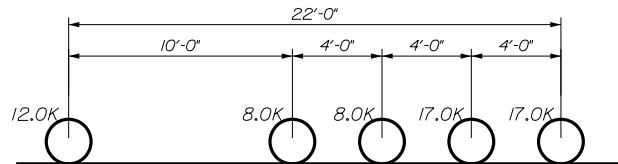

SU6 TRUCK

GVW = 69.5 Kips

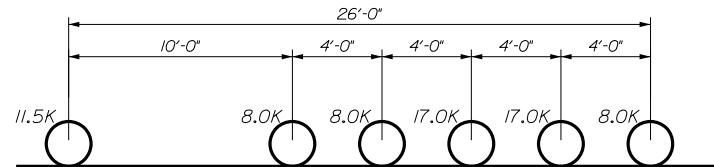

SU7 TRUCK

GVW = 77.5 Kips

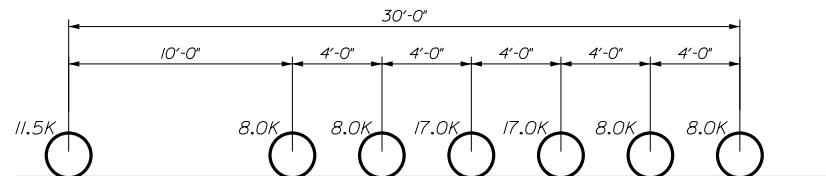

NOTATIONAL RATING LOAD

GVW = 80 Kips

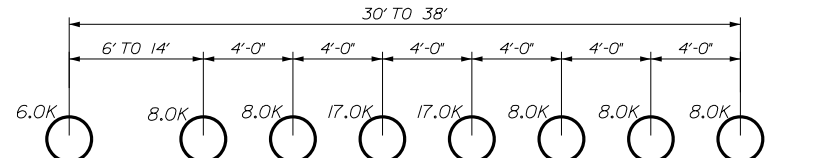

STATE OF MAINE
DEPARTMENT OF TRANSPORTATION

LOADING CONFIGURATIONS
USED FOR BRIDGE RATING

SHEET NUMBER

4

Version 1.3 (3/10/2026)

SHV CONFIGURATIONS

OF 6

RPV CONFIGURATIONS

2-AXLE VEHICLE (RPV 1)

GVW = 39.1 Kips

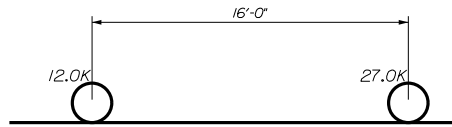

3-AXLE VEHICLE (RPV 2)

GVW = 62.1 Kips

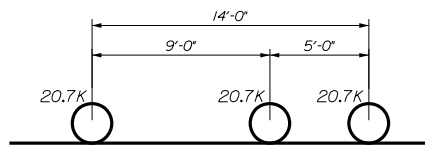

4-AXLE TRUCK (RPV 3)

GVW = 73 Kips

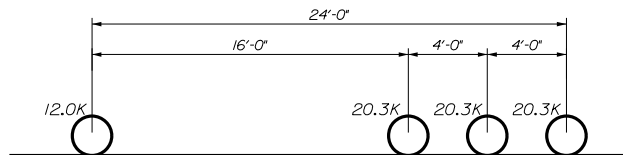

4-AXLE SPECIAL MOBILE EQUIPMENT (RPV 4)

GVW = 110.0 Kips

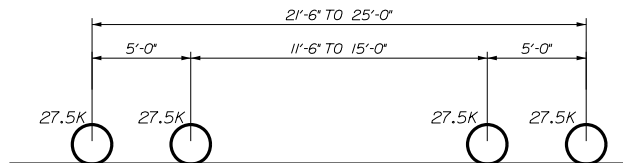

4-AXLE TRUCK/TRACTOR W/SEMI-TRAILER (RPV 5)

GVW = 120.0 Kips

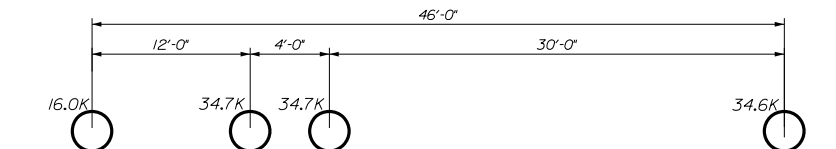

STATE OF MAINE
DEPARTMENT OF TRANSPORTATION

LOADING CONFIGURATIONS
USED FOR BRIDGE RATING

SHEET NUMBER

5

Version 1.3 (3/10/2026)

RPV CONFIGURATIONS 1-5

OF 6

RPV CONFIGURATIONS

5-AXLE TRUCK/TRACTOR W/SEMI-TRAILER (RPV 6)

GVW = 130 Kips

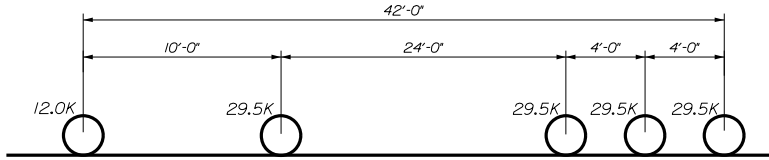

6-AXLE TRUCK/TRACTOR W/SEMI-TRAILER (RPV 7)

GVW = 140 Kips

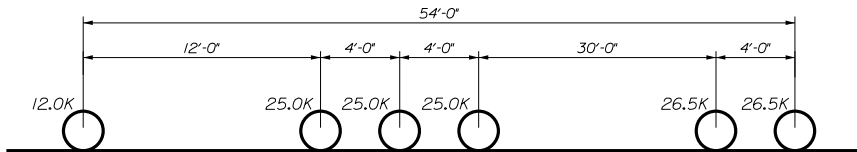

7-AXLE TRUCK/TRACTOR W/SEMI-TRAILER (RPV 8)

GVW = 167.0 Kips

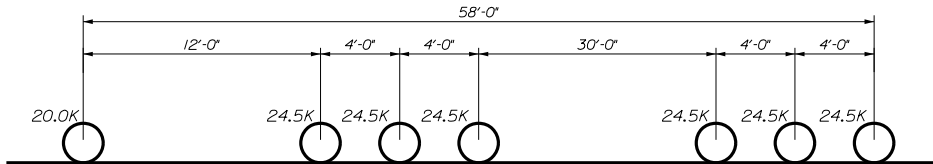

7-AXLE TRUCK/TRACTOR W/SEMI-TRAILER (RPV 9)

GVW = 159.0 Kips

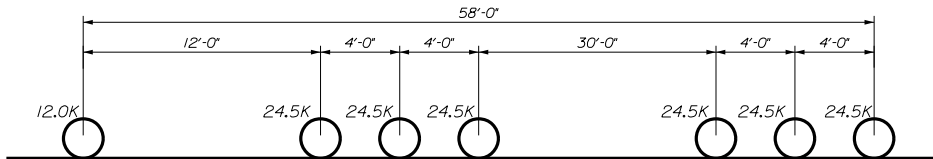

8-AXLE TRUCK/TRACTOR W/SEMI-TRAILER (RPV 10)

GVW = 177.0 Kips

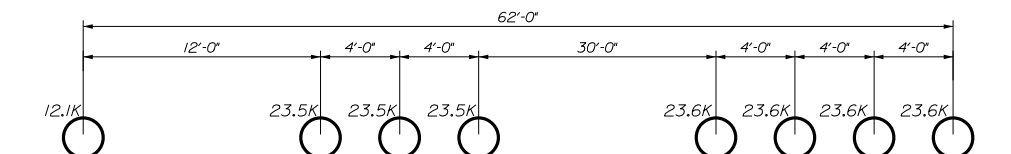

STATE OF MAINE
DEPARTMENT OF TRANSPORTATION

LOADING CONFIGURATIONS
USED FOR BRIDGE RATING

SHEET NUMBER

6

Version 1.3 (3/10/2026)

RPV CONFIGURATIONS 6-10

OF 6